

Please Keep Me Safe

Filter replacement when only used for cold filtered is advised every 6 months, however failure to do so will not void any tap warranty.

To prevent adverse water quality & potential health risks, filters must be changed every 12 months.



## Spare Parts and Service

**sterling**  
SINKS & TAPS

Contact: Sterling  
Phone: 01684 299555  
Fax: 01684 290958  
Email: sales@sterling.eu.com  
Website: www.sterling.eu.com

# STELLA

clearwater®  
THE CLEAR CHOICE

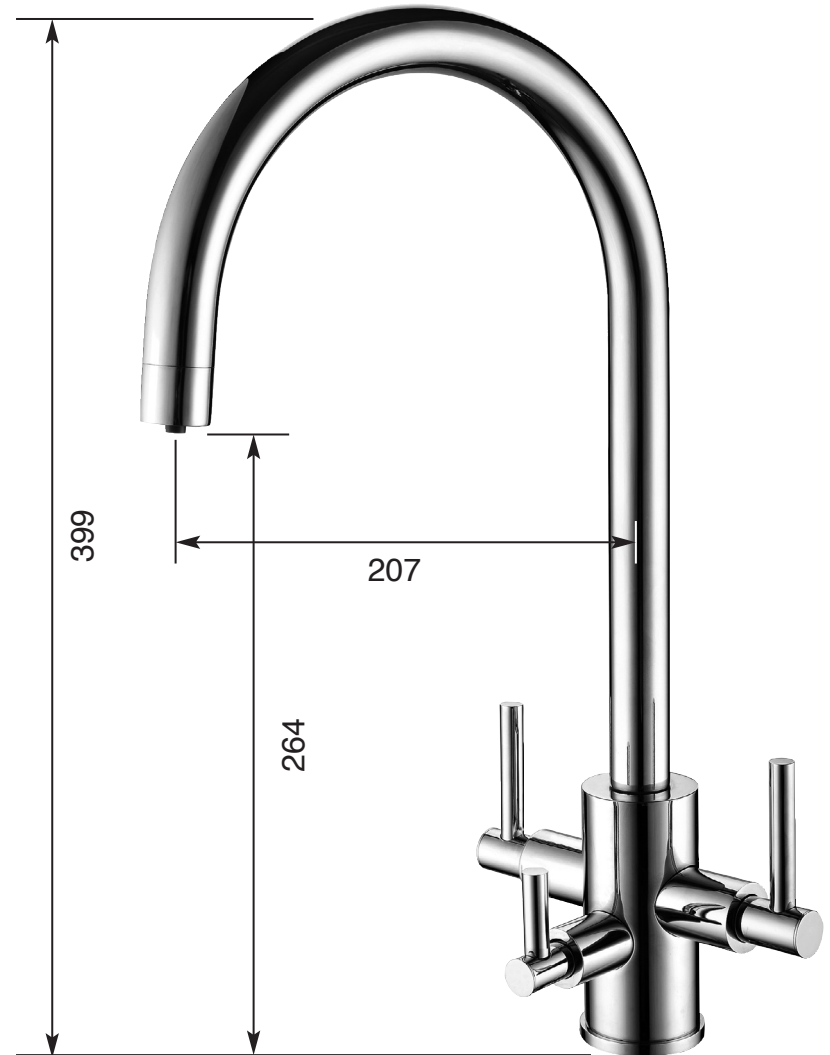

## Fitting Instructions and Parts List

Please read these instructions before you install and use the tap, be sure to keep them safe for future reference and to request replacement parts.

All designs, descriptions and dimensions are subject to change without notice.

## MAINTENANCE

### IF THE FITTING BEGINS TO DRIP

- 1 Turn off the water supply
- 2 Loosen grub screw under handle lever, remove handle and valve
- 3 Carefully clean seating, rubber washer and ceramic disc
- 4 Replace valve and handle, then turn on the water supply
- 5 If problem persists contact our helpline quoting the product code

Where an aerator is fitted to the outlet of the spout, it will need occasional cleaning.

This will be evident when the water flow slows down to an unacceptable level. To accomplish this unscrew the outlet in an anti-clockwise direction and remove the mesh. Immerse the mesh in a suitable descaling fluid overnight, rinse thoroughly in clean water and re-install.

## REMEMBER

Maximum water supply pressure **5 bar (75PSI)** Minimum water supply pressure **0.5 bar**

Maximum hot water supply temperature **70°C**

Recommended hot water supply temperature **65°C**

If these temperatures or water pressure are exceeded, damage to the tap can result. A pressure reducing valve may be required to be fitted in high water pressure situations.

## PREPARATION

We strongly recommend installing particle filters and isolation valves to both hot and cold feeds. This will help to prevent premature failure of valves and make any future maintenance easier.

Flush the plumbing system before installing the mixer tap. This is to void plumbing residues clogging the mesh of the aerated outlet, or possibly damaging the valve's washers. This is especially important where extensive plumbing work has been carried out.

First shut off your water heating system then, with your mains stop cock closed, open the lowest hot and cold taps in the house and allow to run until the cold storage tank and pipes are empty. (The hot water storage cylinder always remains full).

## FLOW PRO REST AND MAINTENANCE

The **Flow Pro** integrates three key functions:

1. **180-Day Timer**
2. **Usage Counter** – Monitors how much filtered water has been unused from a pre set 4000ltrs.
3. **Flow Meter** – Measures water flow rate, when in use. (2lmp is optimum)

### Using the Display

- Press the '**Display**' button repeatedly to cycle through the three functions.
- Stop pressing once your desired function appears.

### Filter Replacement Reminder

- After **180 days**, the Flow Pro will **beep during tap usage** to indicate the filter needs replacing.

### Resetting After Filter Replacement

1. Press the '**Display**' button once.
2. Then **press and hold the 'Reset' button for 5 seconds** until you hear a beep.
3. This resets both the **usage counter** and the **180-day timer**.

### Battery replacement

- Slide tab downwards away from head unit, located on the right-hand side, pull out battery tray and replenish batteries, install in reverse.

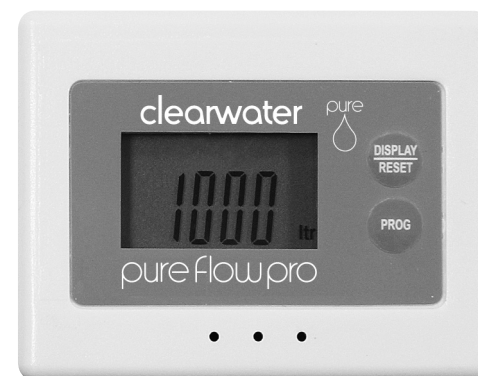

## FILTER REPLACEMENT

- Lay an **absorbent cloth** beneath the filter to catch any residual water.
- Rotate filter **clockwise 90°** to remove.
- Lower the filter away from the filter head.
- Position the new filter under the filter head, ensuring the **locating tabs** are correctly aligned.
- Rotate filter **anticlockwise 90°** until it stops (the arrows on the filter and filter head should align).
- Run filtered water for **3 minutes** to flush out any air pockets.

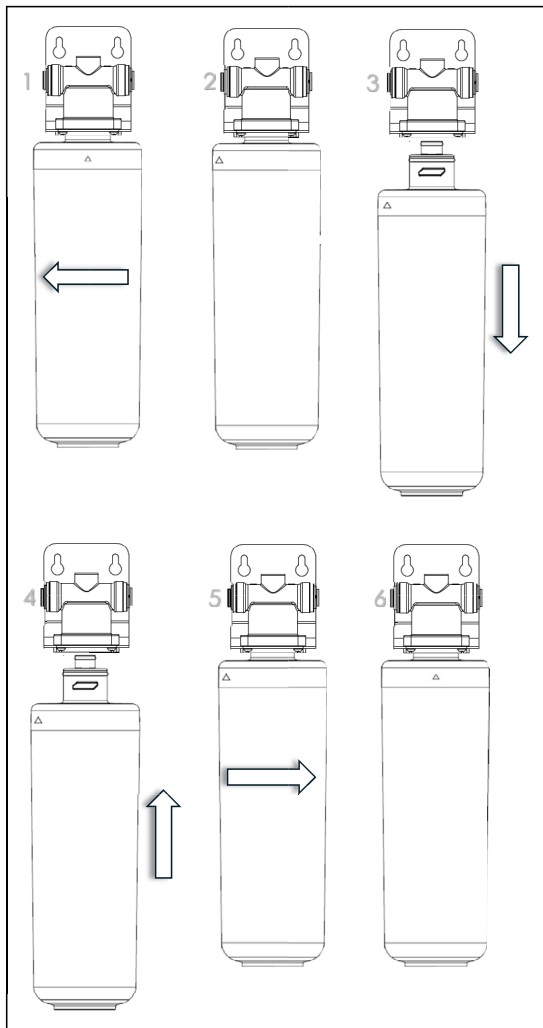

**Replace filter every 6 months.**

## GUARANTEE AND LIABILITY

In the unlikely event that you should experience any defect in the material or workmanship of your mixer tap within 5 years of purchase, we will replace the faulty part free of charge. Decorative surface finishes are guaranteed for one year from the date of purchase provided that our advise concerning care has been observed and no scouring agents have been used. This is provided that the mixer or tap has been used for normal domestic purposes in the UK and that the care, installation and maintenance instructions have been observed.

Scuff and scratches caused by normal wear and tear, improper installation or accidental damage are excluded from this guarantee.

You should retain a copy of your dated invoice as proof of purchase to validate any claims under this guarantee.

No other warranties, express or implied, are made, including merchantability or fitness for a particular purpose.

## AFTER CARE

To maintain the appearance of this tap, ensure that it is regularly cleaned only using a clean, soft damp cloth. A solution of warm water and a mild liquid detergent may be used where necessary, and then the fitting rinsed thoroughly and wiped dry. Abrasive cleaners, scouring cleaners and acid cleaners **must not be used** under any circumstances. All bath cleaning powders and liquids will damage the surface of your fitting even the non-scratch cleaners.

Avoid contact with all solvents and any harsh household chemicals. You will damage the plated finish and void your guarantee.

## PARTS LIST STELLA Ref. ST2

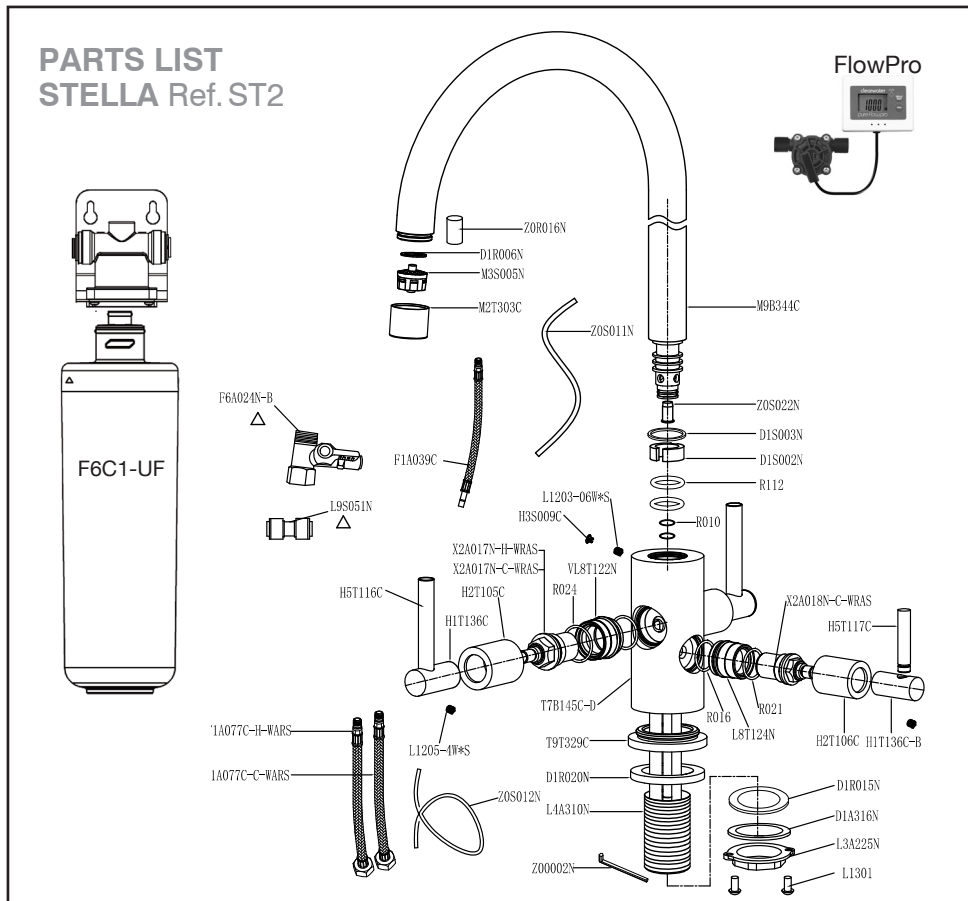

In the unlikely event you find a part missing please contact our Customer Service Helpline on 01684 299555 for immediate despatch of part.

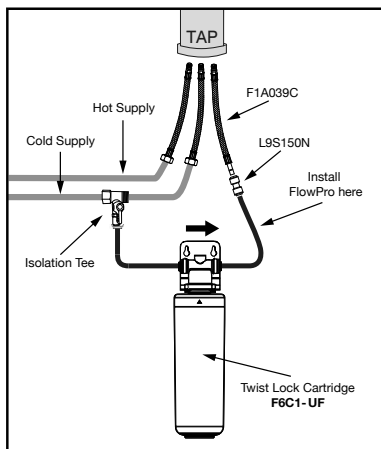

## INSTALLATION GUIDE



## INSTALLATION

- 1) Measure and drill a 35mm installation hole (if installation is directly into worktop).
- 2) Feed the tap into installation hole, place the tap support bracket under the work surface, if work surface is less than 10mm thick. Place the rubber, then metal washer over threaded shank, before installing the fixing nut - hand tight. Use the outer 2 screws on the fixing nut to achieve the final securing torque figure.
- 3) Install Hot, cold and filtered supply tails into the base of the tap, handle tight.
- 4) Install Isolation Tee (F6A024N-B) onto cold feed pipework and install cold tail onto the top threaded section. (tighten tail nut to 6nm)
- 5) Install Hot tail to hot mains supply. (tighten nut to 6nm)
- 6) Finalise location of the filter head and secure using 2 screws. (making sure there is at least 30mm free space below the filter to allow for easy filter replacement).
- 7) Install filter, with a quarter turn anticlockwise - when from above.
- 8) Using 1/4" pipe supplied (ZOS012N), measure and cut the necessary length required to complete connection from the Isolation Tee to the Left-hand side of the filter head. Install once cut, ensuring at least 10mm of pipe is inside the push fittings.
- 9) Using the remaining 1/4" piping, measure and cut the necessary length required to complete connection from the right-hand side of the filter head to the filter tail (F1A039C). Install once cut, ensuring at least 10mm of pipe is inside the filter head fitting.
- 10) Complete filtered water supply by installing straight connector (L9S051N), on to the filter tail (F1A039C), ensuring at least 10mm of pipe is inside the filter head fitting.
- 11) Locate a free space in the filter water line to install the 'Flow pro', cut the 1/4" pipe in your chosen portion and install, ensuring at least 10mm of pipe is inside the filter head fitting. (note direction of flow arrow on flow-pro body)
- 12) Install 'Flow-Pro' head unit carrier into your chosen position in the cabinet, install the batteries and ensure the cable connection better meter and head unit is secure.
- 13) Open isolation valves and allow 10 litres of Hot and cold water to flow from the spout.
- 14) Open filtered water isolation using the lever on (F6A024N-B) Isolation Tee.
- 15) Operate the filtered water function for 3 minutes to flush the system of any trapped air.
- 16) Use isolation Tee to adjust flow rate to between the recommended range of 2-4 litres per minute.